

# CAMPAIGN for the Mid-Pennine Centre FOR THE ARTS

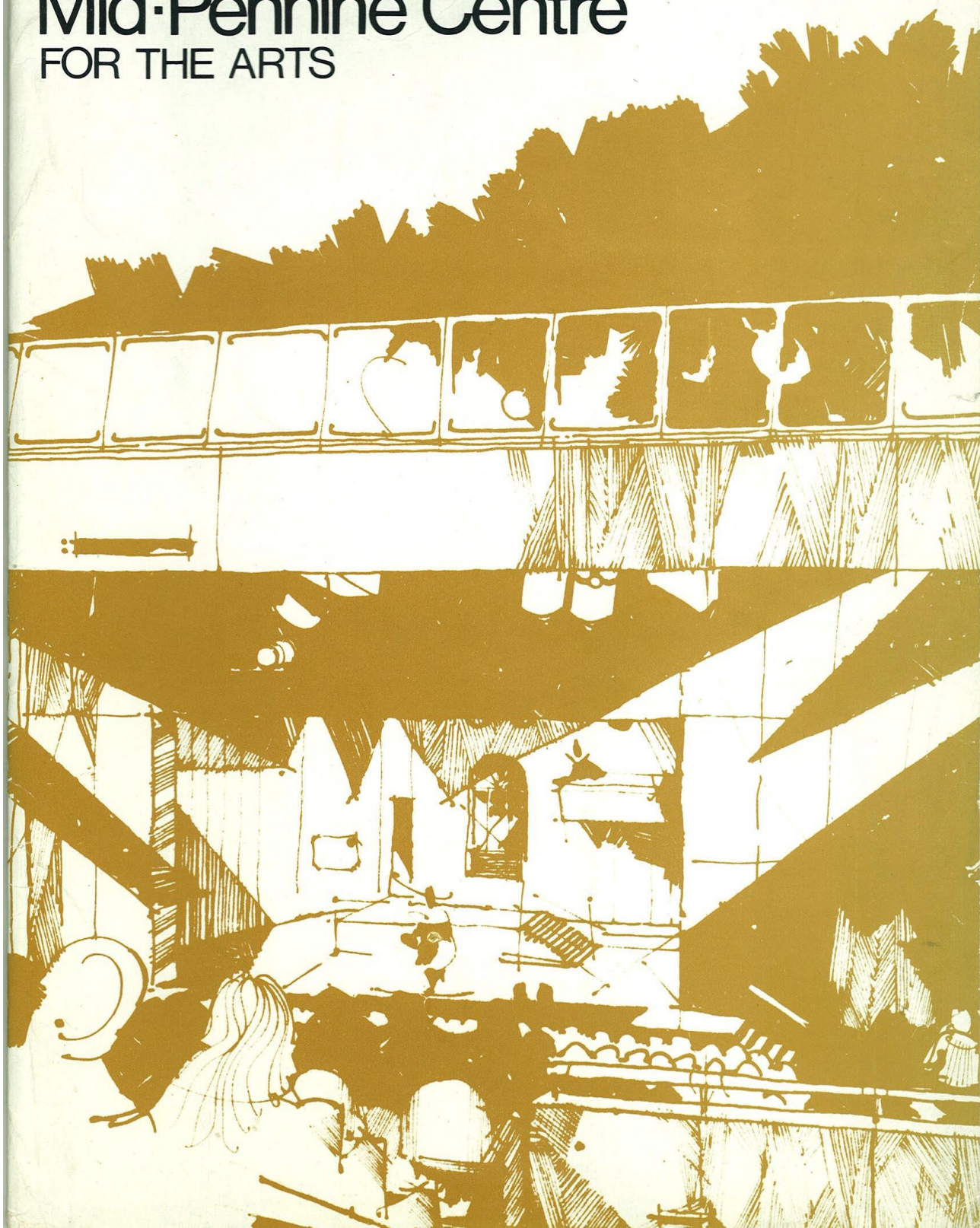

## Mid-Pennine Centre for the Arts

“ The object of our policy is to involve  
as many people as possible in activities which  
develop their intellectual, aesthetic and creative  
capacities.  
These activities must be available near where they live:  
The choices open to them must be wide  
since what interests one man does not interest another. ....  
A range of activities should be available in all centres of population.”

*Lord Eccles*  
*Minister with responsibility for the Arts*  
*June 1971*

Lord Eccles has concisely stated the principle: the  
Mid-Pennine Association for the Arts is concerned to  
make that principle a reality in the area it serves.

# What the Centre is

- for YOUR enjoyment.
- easy to get to. Just opposite Burnley Bus Station, and close to good parking facilities.
- open seven days a week, from 10.0 a.m.
- multi-purpose. You can watch a film or play, read a book, have a meal, paint a picture, chat develop your holiday snaps or your interest in early music, all under one roof.
- for people of all ages, occupations and interests.
- a powerhouse, able to provide the area as a whole with increased arts activity locally and centrally.
- a place for now, a place for the future, where children and grandchildren of today will still enjoy themselves with their children.

# Design of the Centre

The design strategy for the Mid-Pennine Centre for the Arts is based upon extending public involvement in two ways:

Firstly, by providing professional production facilities for the M.P.A.A.'s own arts programmes. These activities will radiate from the Centre into the surrounding towns and villages;  
Secondly, by providing facilities for public use so that interest can develop into participation.

The many directions in which the Centre may develop in the future cannot be determined at this stage. The Centre must therefore represent a flexible statement of intent into which diverse interest can be injected at different points in time.

Theatre is a multi media art form involving many professional skills. Therefore as a nucleus upon which many other art forms can react and from which they can extend, theatre forms the focus of the Centre both spectators and participatory activity.

The flexible arrangements of the auditorium once defined remain constant. Services to the building in terms of administration, catering, air conditioning, lavatory provision etc. are also calculable. These two elements therefore form the linear core to the building alongside which all other production spaces and multi-purpose areas can be set, to connect, expand or change function as time and growth dictate.

Design Syndicate

Architects

# Theatre and Studio

## PROSCENIUM STAGE

The stage in this arrangement can be used for opera and ballet performances, drama and musicals. It can be used for conferences or public meetings, and concerts. The 'trapped' area covers an orchestra pit.

## THRUST STAGE

Though this form of staging is more usually associated with drama, there is no reason why this cannot be used for music, or modern dance.

## THEATRE-IN-THE-ROUND

Again, a form often associated with drama only but one which can be most successfully used for folk concerts, informal revue-type shows, fashion shows or spectacles.

## TELEVISION

The drawing showing the theatre in use as a television studio is one indication of the many uses the theatre alone can have. As we now have local radio stations, and increased use of local facilities by national television companies, (of Bolton's Octagon folk shows) it seems likely that this will increase in the future, hence we provide for it.

## RADIO

Assuming the continuance of local radio stations, provision for a studio is envisaged in the building.

## REHEARSAL STUDIO

Positioned at the back of the main auditorium, this area has a number of uses. The resident company can rehearse incoming productions, as can any touring company using the theatre. Drama workshops sessions for schools and young people can be held here, and the studio can become a small auditorium for events such as experimental plays, recitals, jazz concerts etc. Like the main auditorium, it will have moveable blocks of retractable seating.

## GENERAL TECHNICAL INFORMATION

As yet, this can only relate to the theatre, as the development of other arts facilities is still in the planning stage.

Given the adaptability of the theatre, there are a number of general technical details that will be of interest to amateur societies in particular, and the public in general.

For proscenium staging, there are full flying facilities planned. On other forms of staging, some flying is possible, though proportionately less, as will be seen from the section and plans.

Provision has been made for an orchestra pit for ballet, opera and musical productions.

The ancillary facilities of a theatre such as dressing-rooms, workshop, wardrobe and laundry, and rest rooms will be of the highest possible standard of comfort.

The main auditorium seating is on large moveable blocks which are retractable; this is the means by which the three forms of staging have been achieved, and it is intended that the auditorium can be quickly cleared to a large open area, which could be used for a banquet or flower show.

As at present planned, it is possible to vary the seating capacity of both the performance areas to accommodate activities.

The lighting and sound equipment will be the best available. The bridges spanning the performance area and the side galleries running round the two auditoria will provide easy access to all lighting units and will enable equipment to be positioned quickly to cover any part of the auditorium. The stage lighting and sound control units will be in a box above the performance areas, giving the operators a clear view of the stage.

The control box will also house cinema projection equipment, television cameras and control equipment. Closed circuit television and sound will be relayed to all parts of the Centre.

## How you can help

The MPAA invites you to make a donation to the Centre's Building Fund for one of the following:

Named seat in the theatre	£25
Anonymous seat in the theatre	£15
Donor's name engraved on the entrance foyer glazing	£10
Music stand or individual auditorium amplification	£5
Restaurant table place setting	£2.50p
Building block	50p

If you, or the club you belong to, feel inclined to donate more than one item, we would naturally be delighted. In any event, all donations will be recorded in the Building Book on display in the entrance, providing a permanent record of those who helped to build the Centre.

Longer term support under Deed of Covenant is also very welcome. Supporters who pay income tax at the standard rate can undertake to subscribe to the Building Fund annually for seven years. The Deed of Covenant enables the MPAA to recover the income tax and hence increase the donation.

If you prefer to make a donation monthly or annually, a Bankers Order form is attached for this purpose. We would point out, however, that the MPAA can only recover the income tax under a Deed of Covenant.

**DEED OF COVENANT**

I .....  
of .....

hereby covenant with the Mid-Pennine Association for the Arts that for a period of seven years from the date hereof or during my life, whichever period shall be shorter I will pay to the Association annually such sum as after deduction of tax at the Standard Rate will amount to £ ..... such sum to be paid from my general fund of taxed income so that I shall receive no personal or private benefit from the said sum or part thereof.

Signed sealed and delivered by

Signature .....

this ..... day of .....

this ..... day of ..... 19.....

Witness .....

Occupation .....

Address .....

.....

**BANKER'S ORDER**

To (your bank) .....

Branch address .....

Please pay to Barclay's Bank Ltd., 8 Manchester Road, Burnley for the credit of the Mid-Pennine Association for the Arts (Building Fund) the sum of £ .....

**MONTHLY**

Now and on the ..... day of each succeeding month for the next ..... months (..... monthly payments in all).

**ANNUALLY**

Now and on the ..... day of the month of ..... in each succeeding year for the next ..... year (..... annually payments in all).

**DEED OF COVENANT**

Now and on the..... day of the month of ..... in each succeeding year for the next six years (seven annual payments in all).

Signature .....

Address .....

Please return this form to the MPAA, 28 Back Saint James' Street, Burnley.



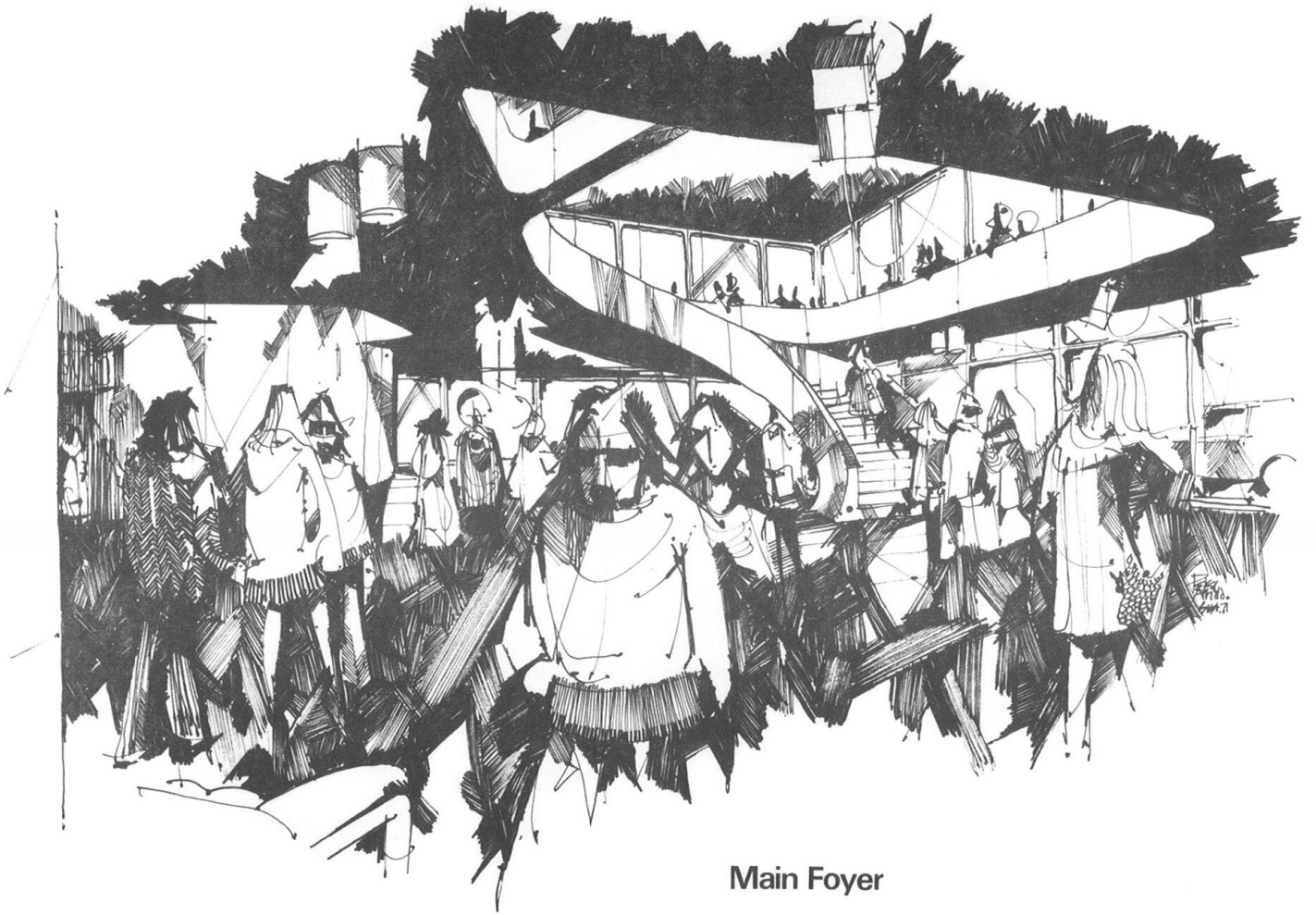

Main Foyer

SECTION 1 Shows a section through proscenium stage in main auditorium and rostra seating for music recital in rehearsal studio.

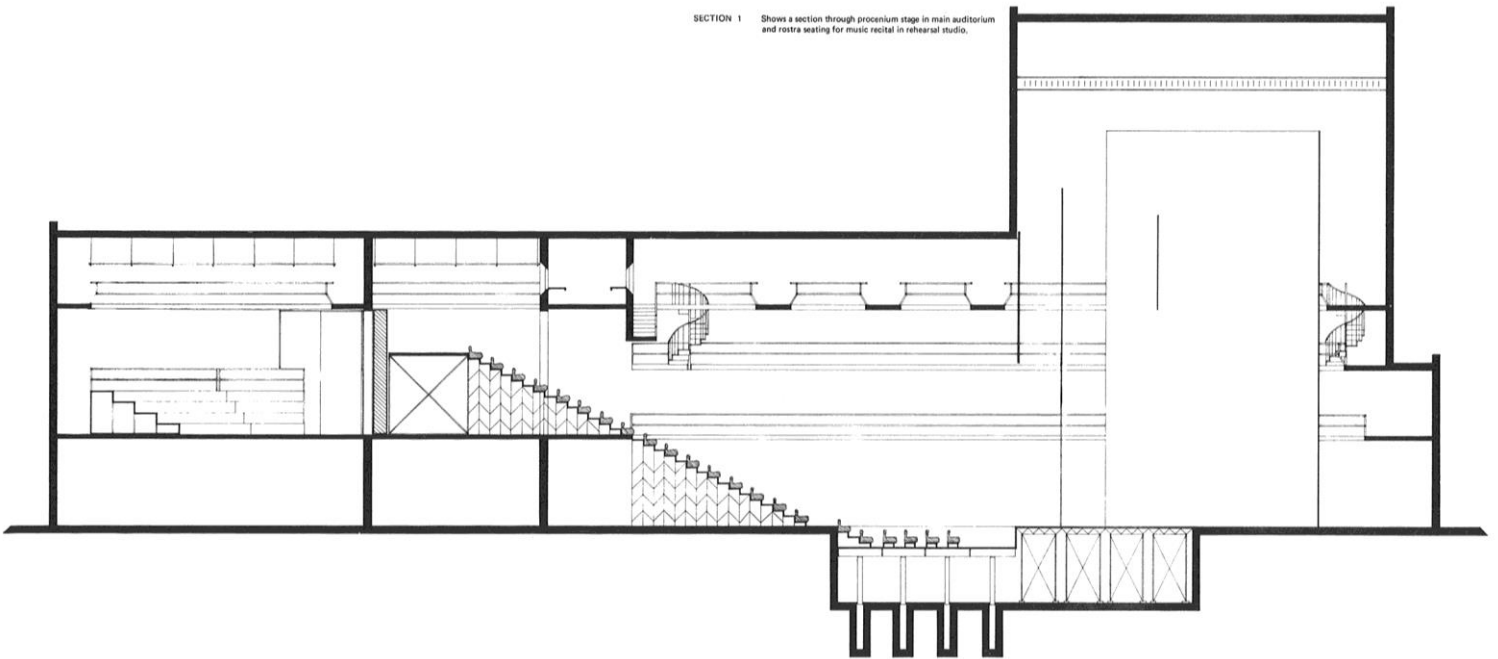

PLAN 1 MAIN AUDITORIUM Proscenium stage 11 x 16m, seating 668.  
Rehearsal studio for recital, rostra seating 200.

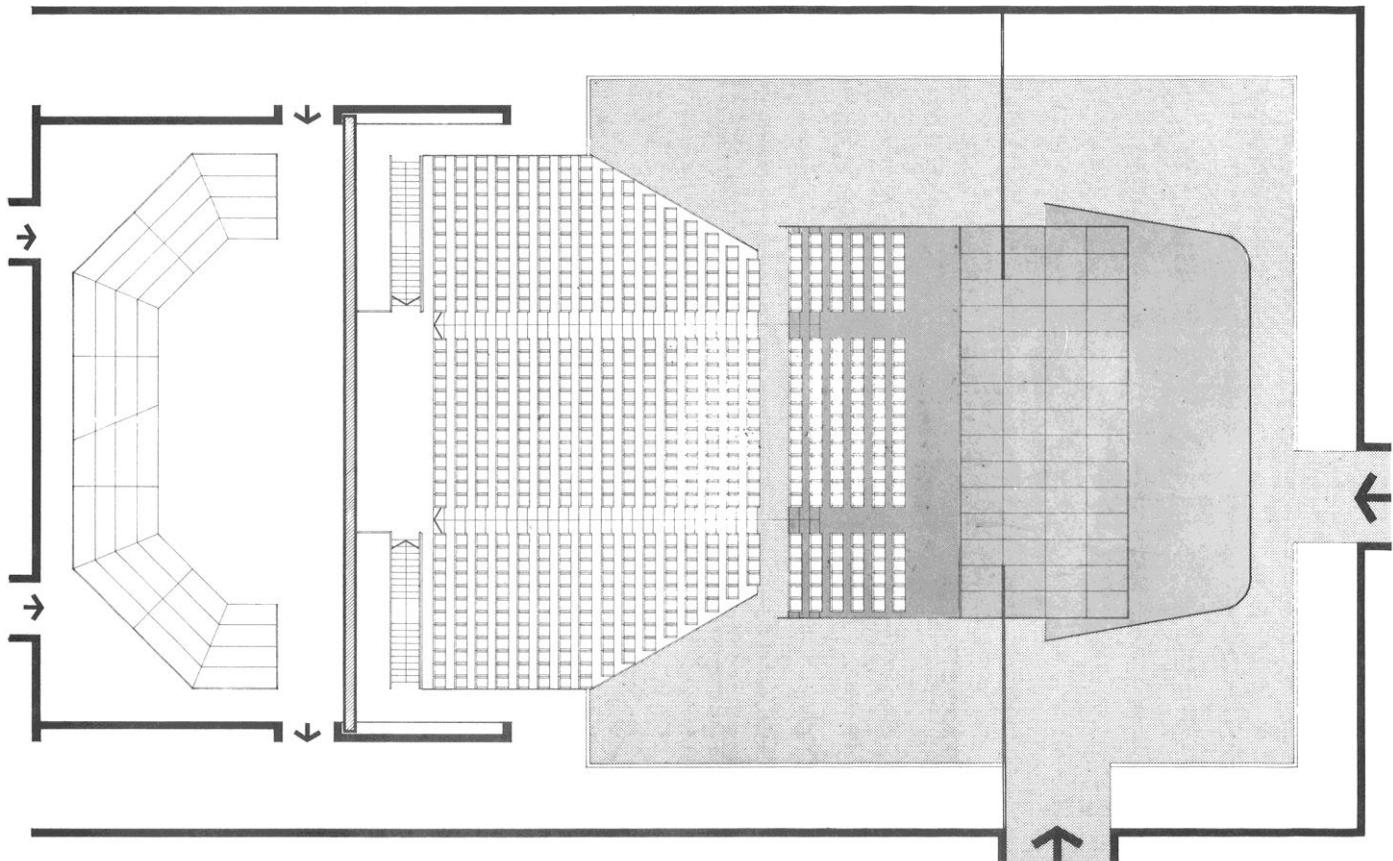

Section 2 Shows a section through End stage in main auditorium and small End stage in Rehearsal studio.

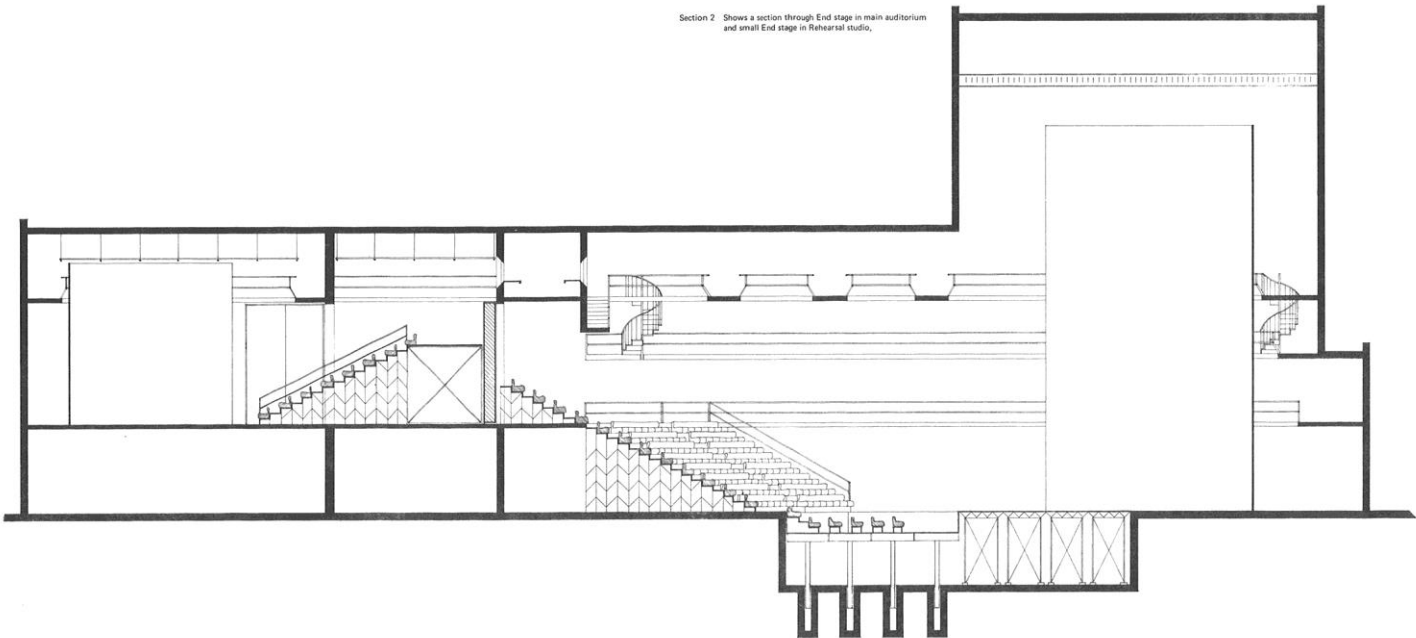

PLAN 2 MAIN AUDITORIUM End stage 24 x 10m, seating 534.  
Rehearsal studio small End stage, rooms seating 200.

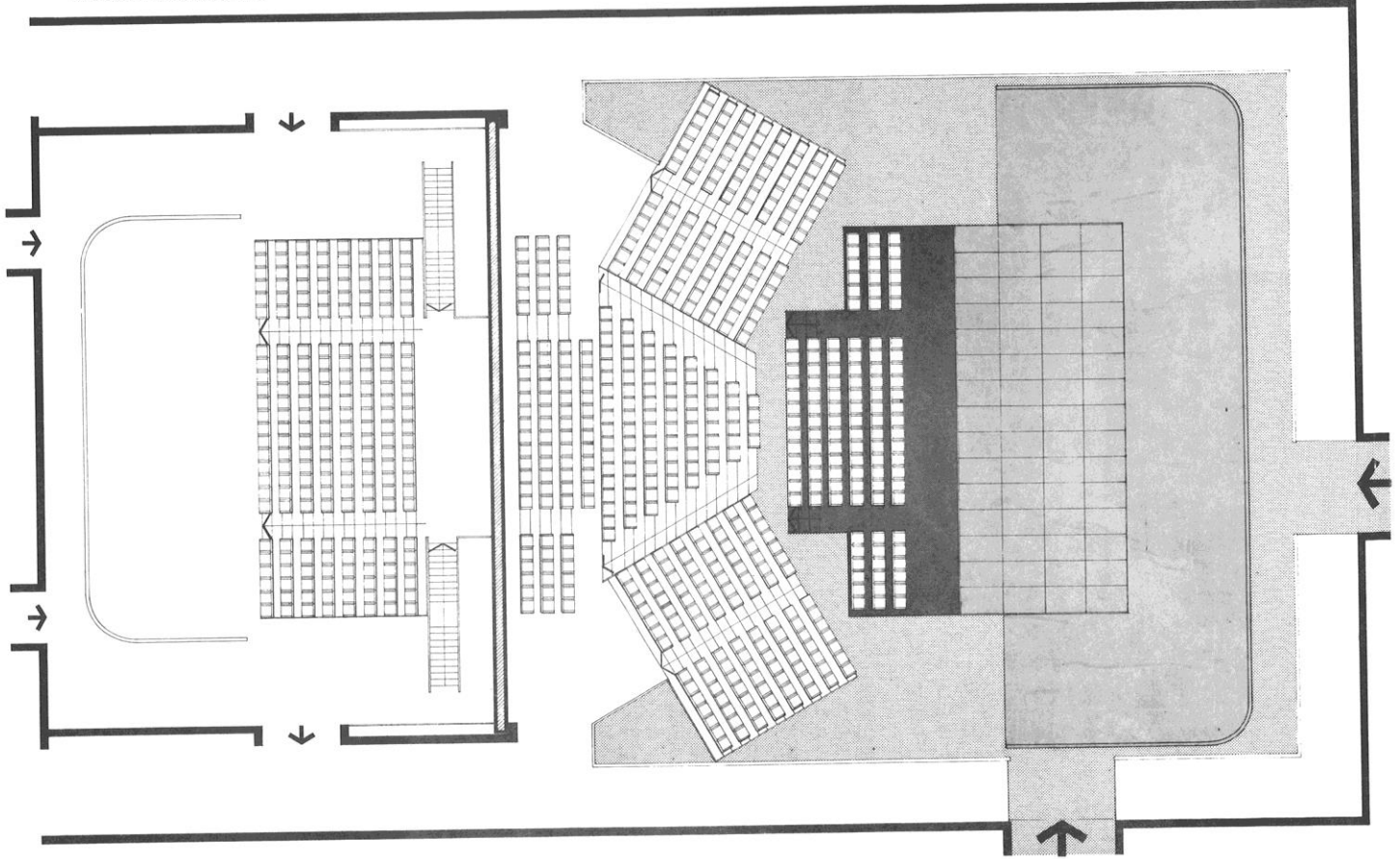

Thrust Stage

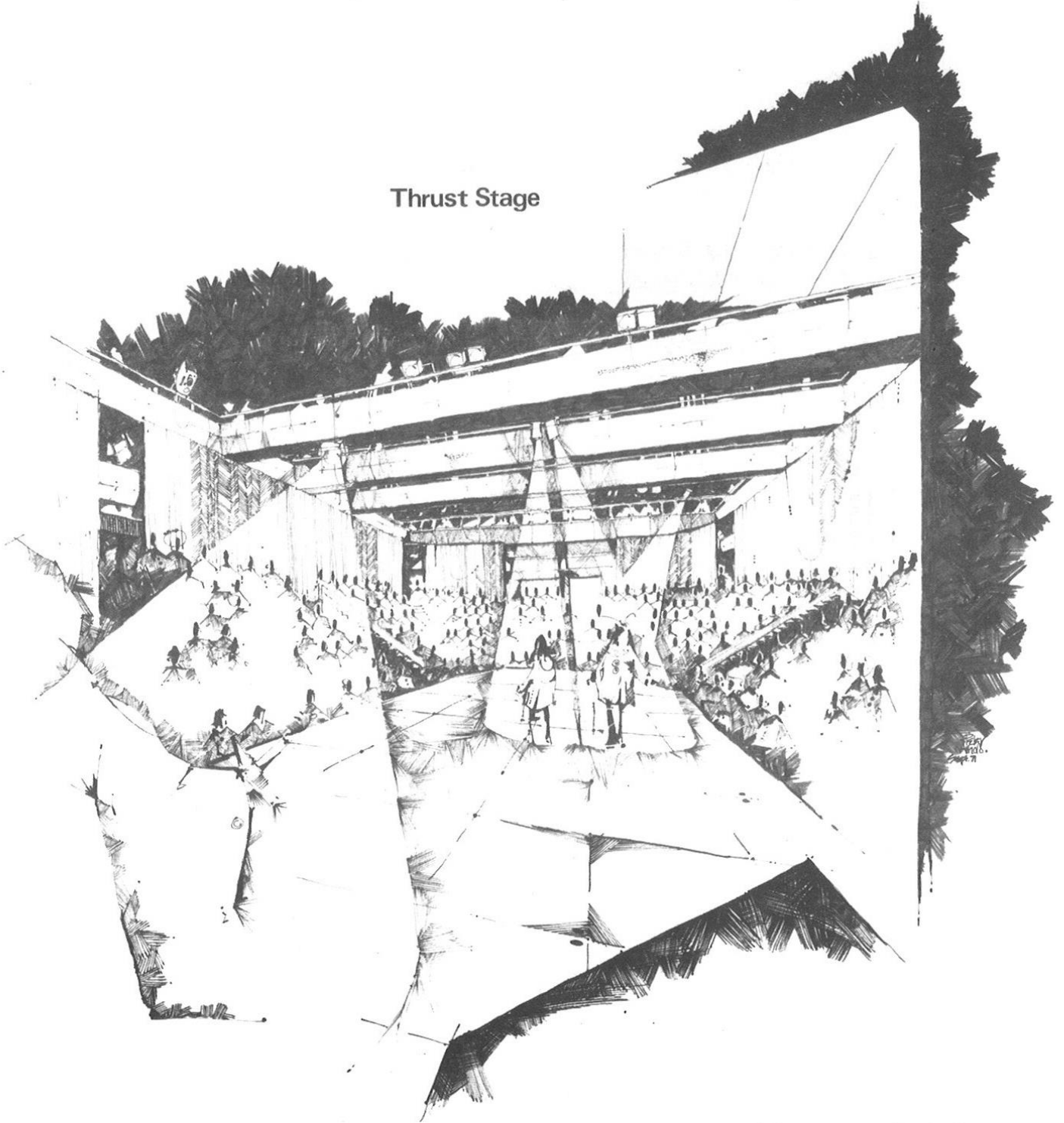

PLAN 3 MAIN AUDITORIUM Thrust stage 18 x 6.5m, seating 536.  
Rehearsal studio theatre in the round 8m stage, rostra seating 280.

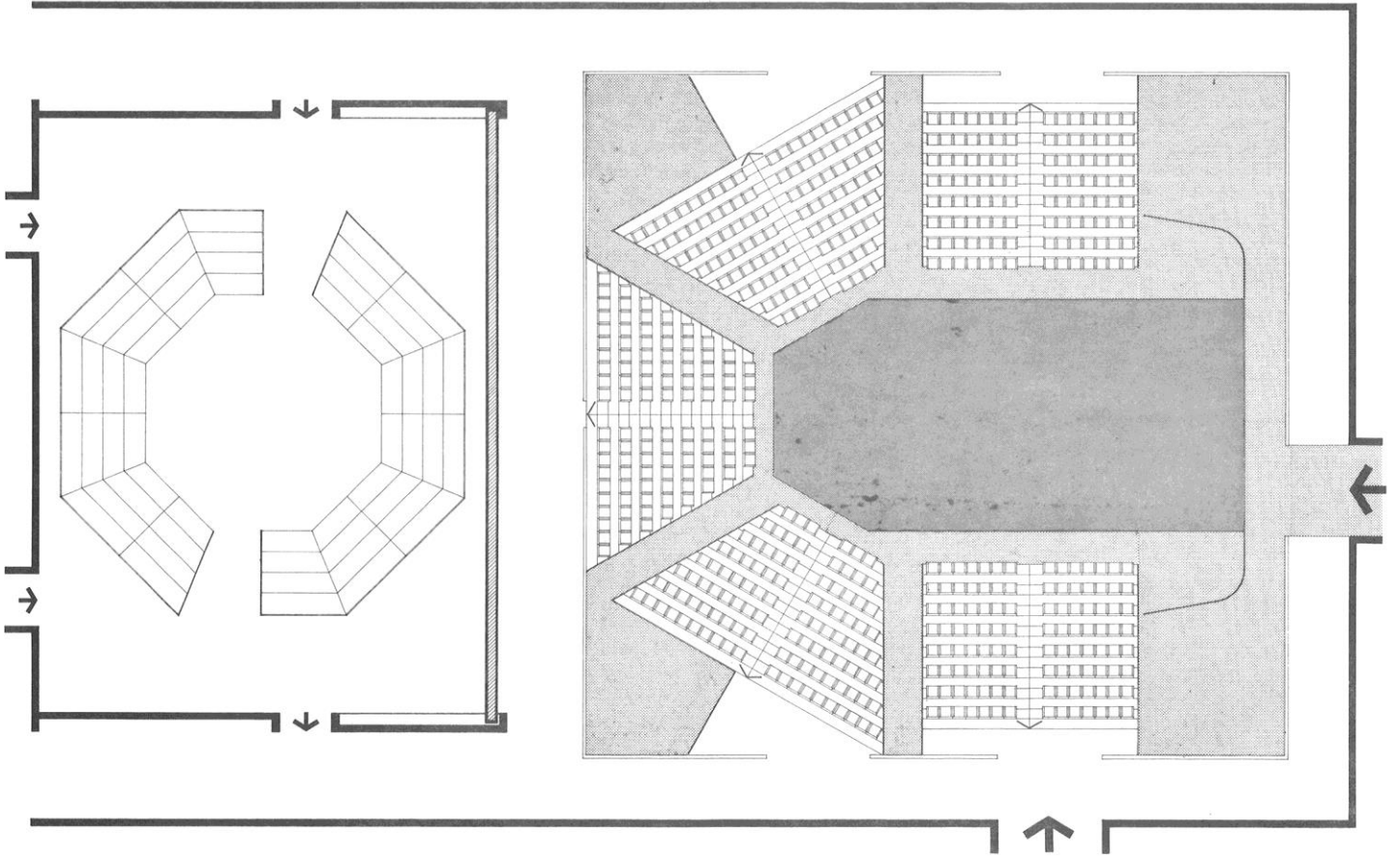

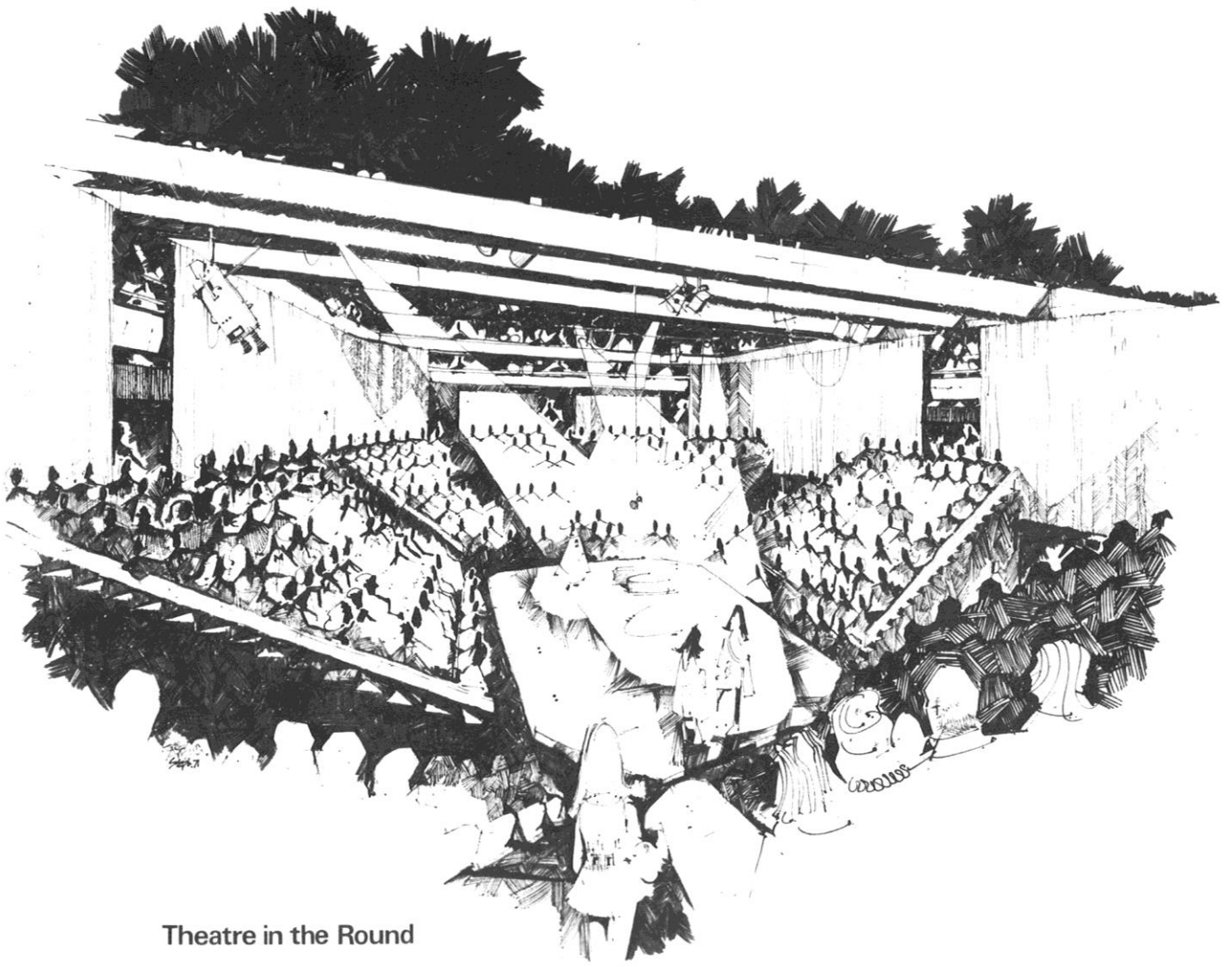

Theatre in the Round



PLAN 4 MAIN AUDITORIUM Theatre in the round 8.5m. stage, seating 624.  
Rehearsal studio in the round for Dance, rostra seating 360.

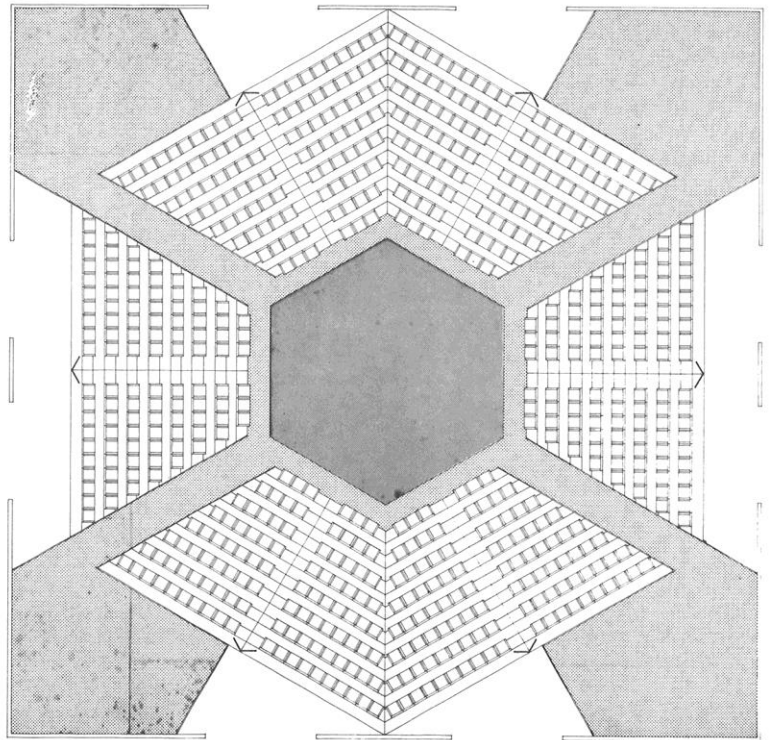
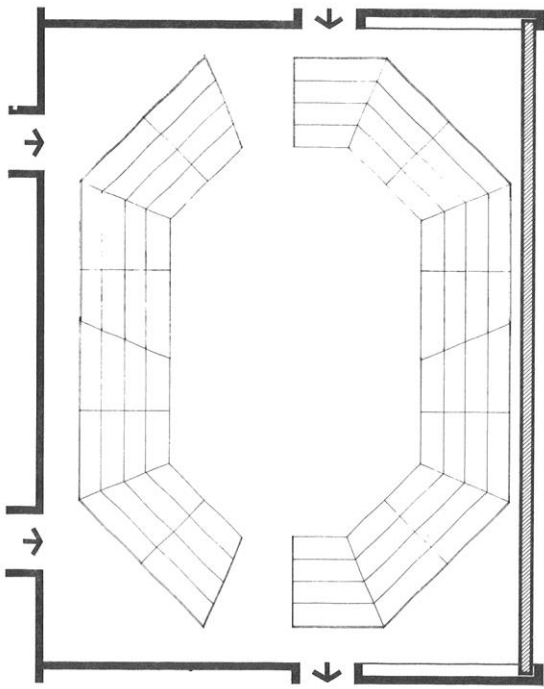

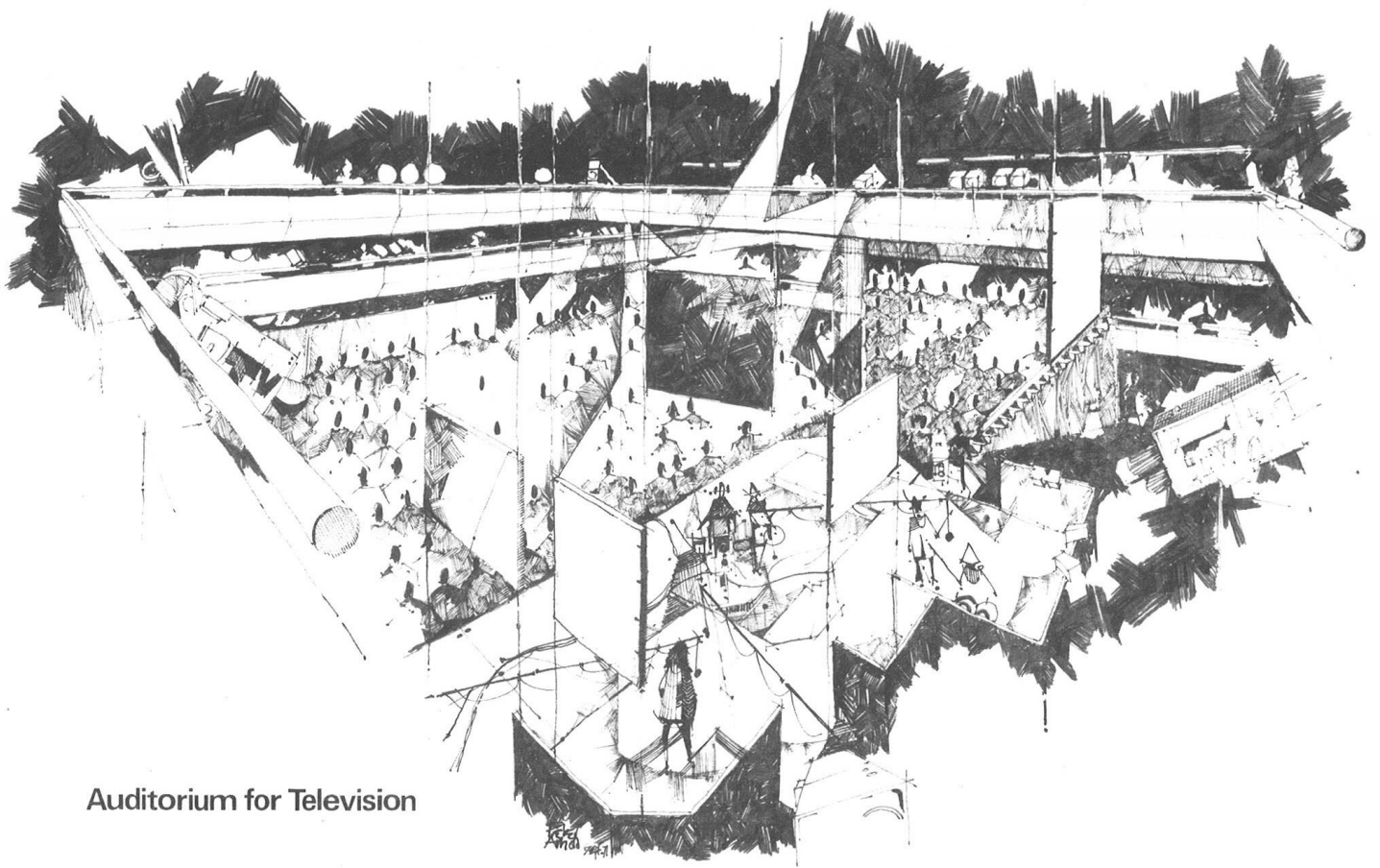

Auditorium for Television

This could be the programme for the area for one day in the late 1970's

	Morning	Afternoon	Evening
BARNOLDSWICK	Drama workshop		Theatre Mobile : play
EARBY	Puppet making and play	Drama workshop	
BARROWFORD		Drama workshop	
NELSON	Drama workshop		Exhibition opening
BRIERFIELD		Music workshop	
BURNLEY	SEE SEPARATE SHEET FOR DETAIL OF CENTRE PROGRAMME		
TODMORDEN	Music workshop		Concert
BACUP		Street play	
WHITWORTH		Street play	Puppet play
ACCRINGTON	Drama workshop		Recital
OSWALDTWISTLE		Drama workshop	Folk evening
PADIHAM	Drama workshop		

**Note:** This programme is to give you some indication of what could be happening on a Saturday, when the emphasis is to a large extent participatory, and numbers of young people are accustomed to the drama workshops as at present, and the music workshop to come. Hopefully, the puppet activities would be an indigenous part of the MPAA's activities throughout the area, from the base in Burnley.

This could be a day's programme in the Centre itself.

	Morning	Afternoon	Evening	Late Night
MAIN AUDITORIUM	Children's show	Puppets	Ballet	Folk
STUDIO	Drama Workshop	Ballet teach-in		
FILM VIEWING	Children's show	Cartoons	Feature film	Film
FOYER	Exhibition			
MUSIC	Practice rooms in use + lunchtime recital			
CRAFTS WORKSHOP	Public use all day			
THEATRE WORKSHOP	Society use	Theatre company use rest of day		
PHOTOGRAPHY	Public use all day			
RESTAURANT/COFFEE BAR	Open all day			



Brochure donated : Print | Turner and Earnshaw  
Graphics | A H Mills